



APT-P Expansion Set.

For the original Hornby APT-P

00 Gauge Model Railway Kit.



Not suitable for children under the age of 12.

As with all plastic models, DO NOT STORE in direct sunlight.

Tools required :

Needle files, flat and rounded.
Glue (I use Revell Contacta Professional)
Fine sand paper
Patients.....

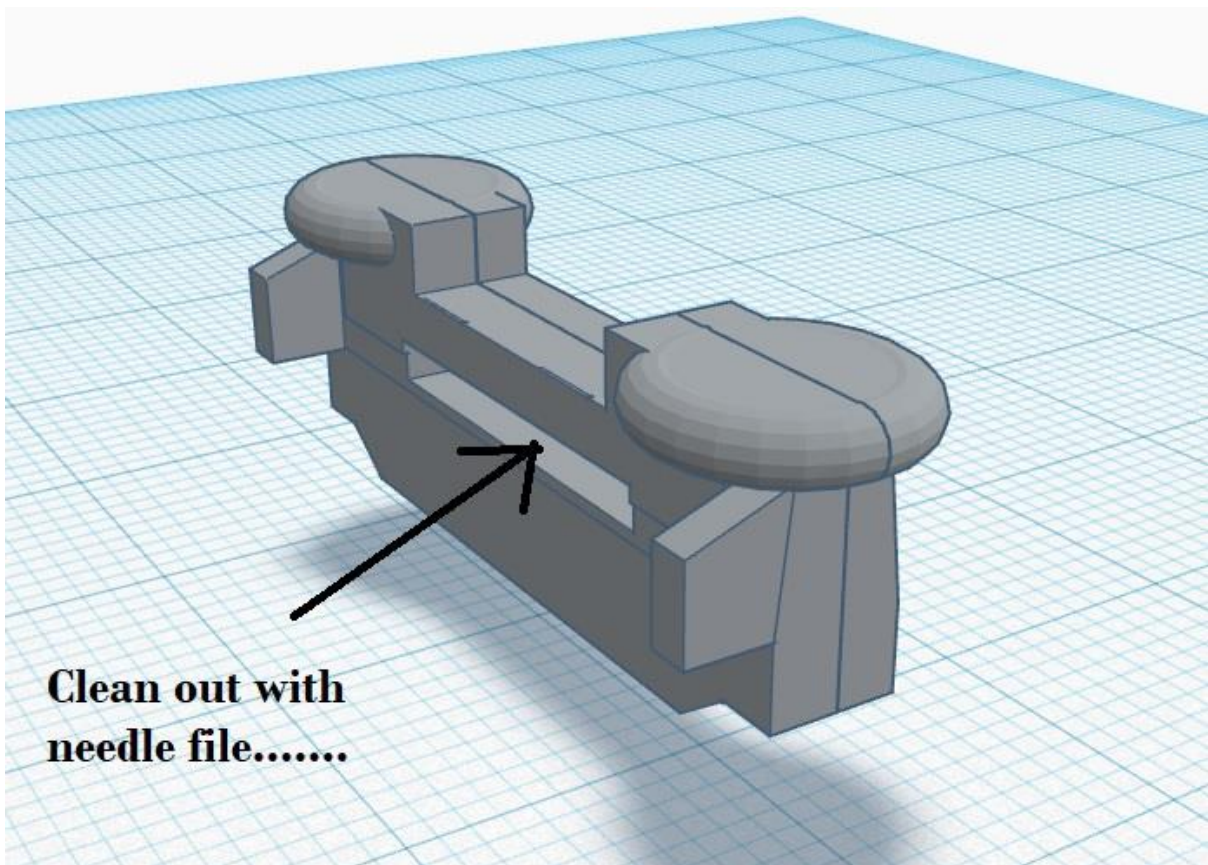
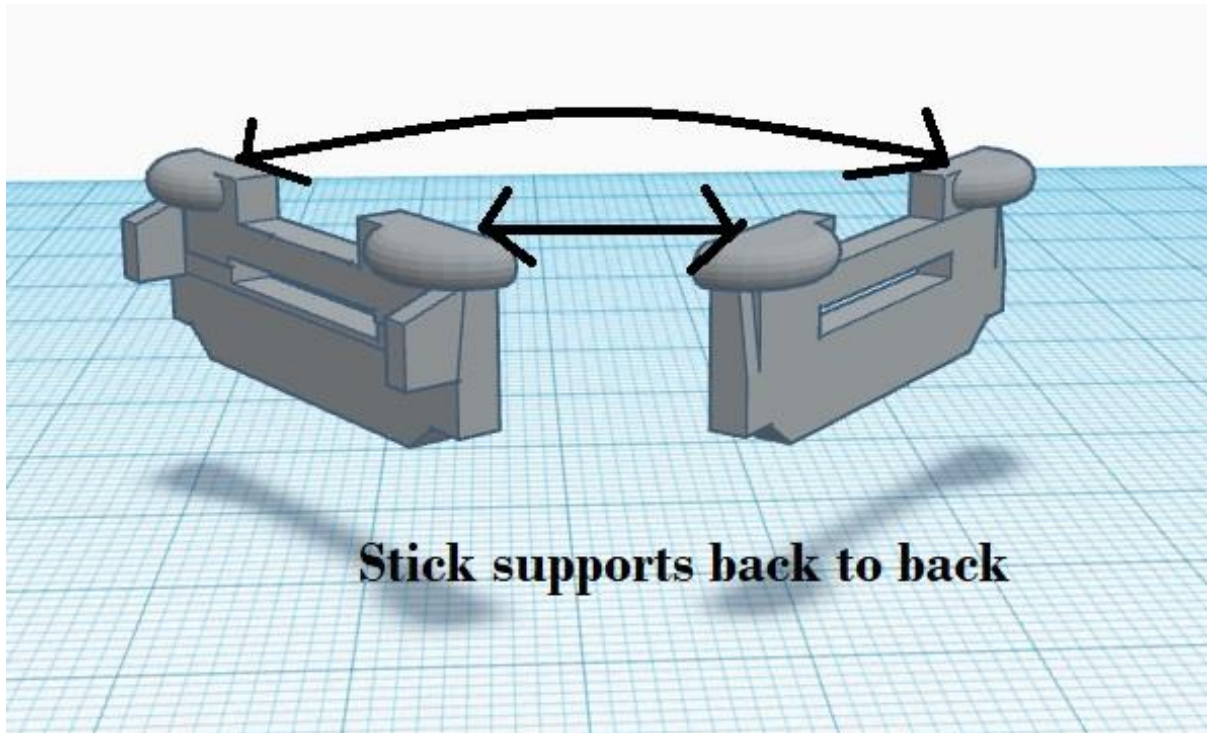

BT 11 Half Bogies

Fit original bogie into position.
Make sure its fully fitted and as
far in as it can go.
Make sure it stays straight.

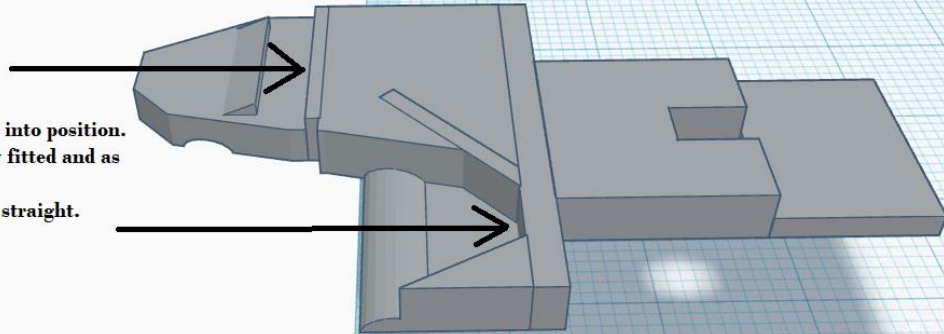

Fit the retaining plate.
Flush to edges.

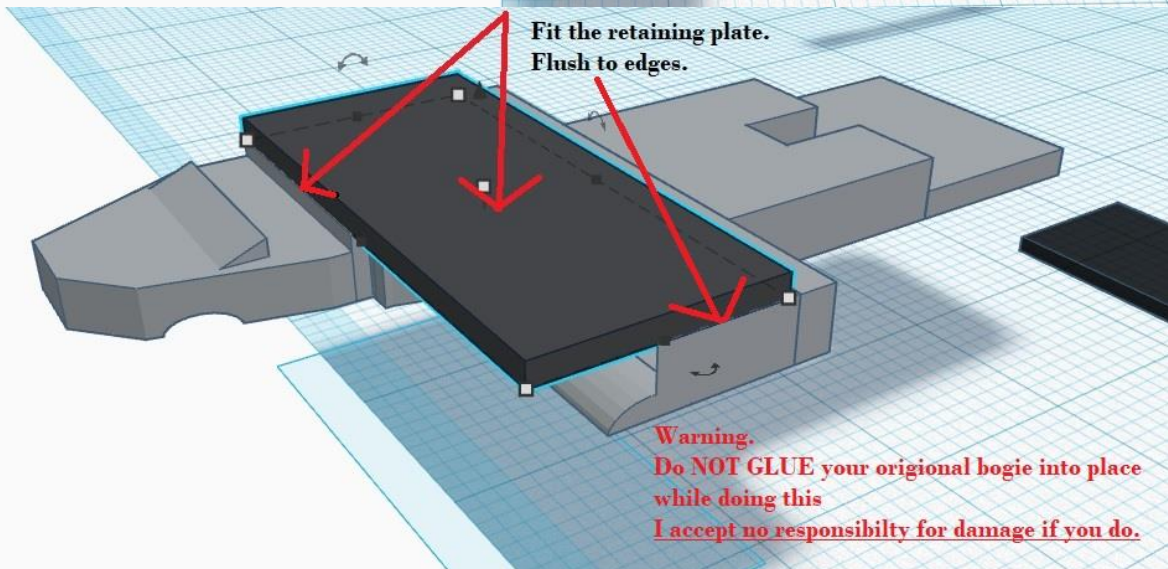

Warning.
Do NOT GLUE your original bogie into place
while doing this
I accept no responsibility for damage if you do.

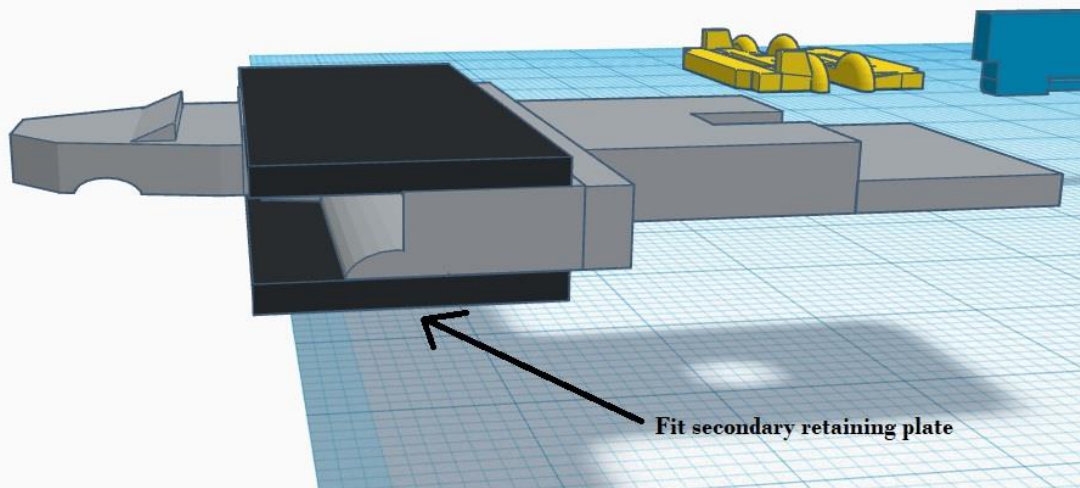

Fit secondary retaining plate

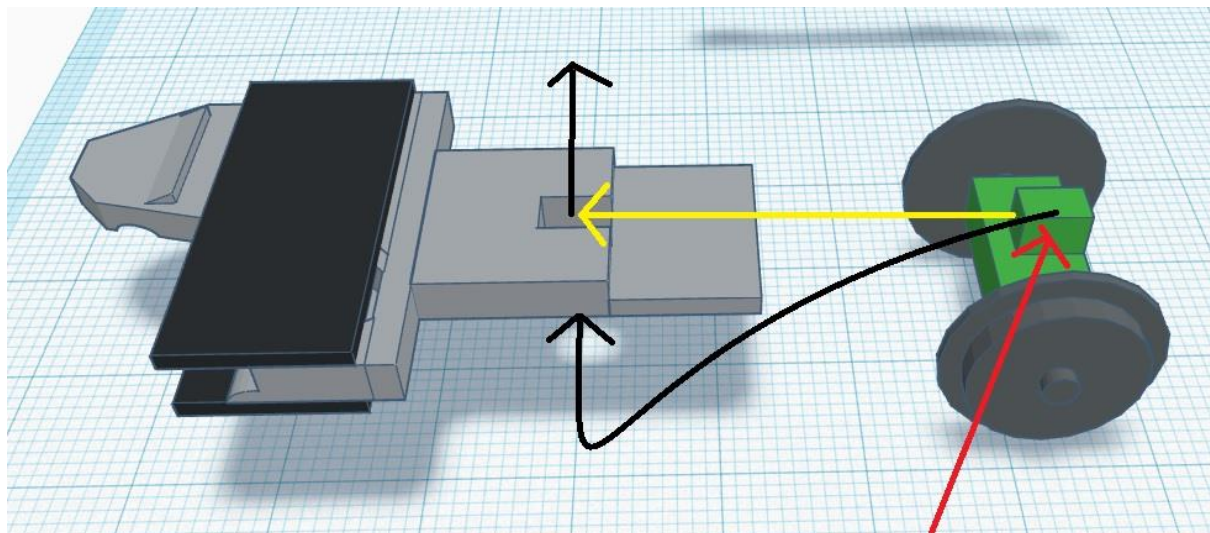

Fit wheel holder into base.
Make sure wheels run freely, use a needle file if required.

File to fit. Must be a tight fit.

Note position of lug.

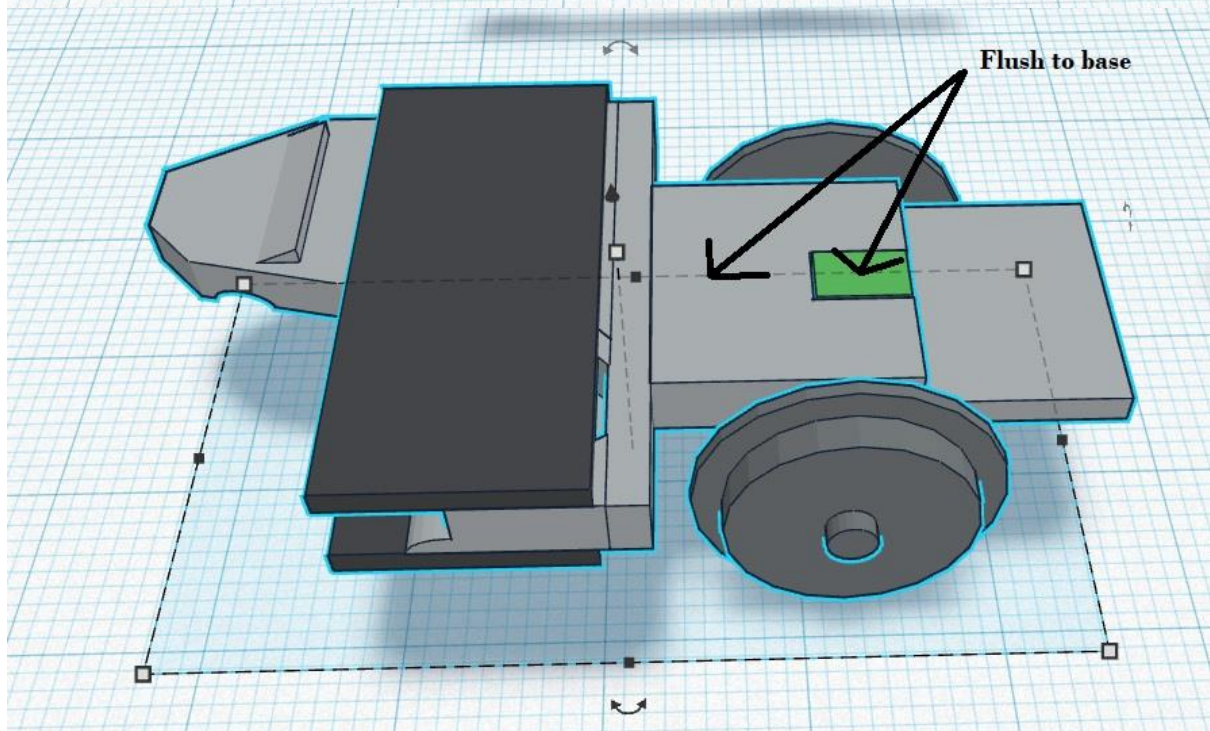

Flush to base

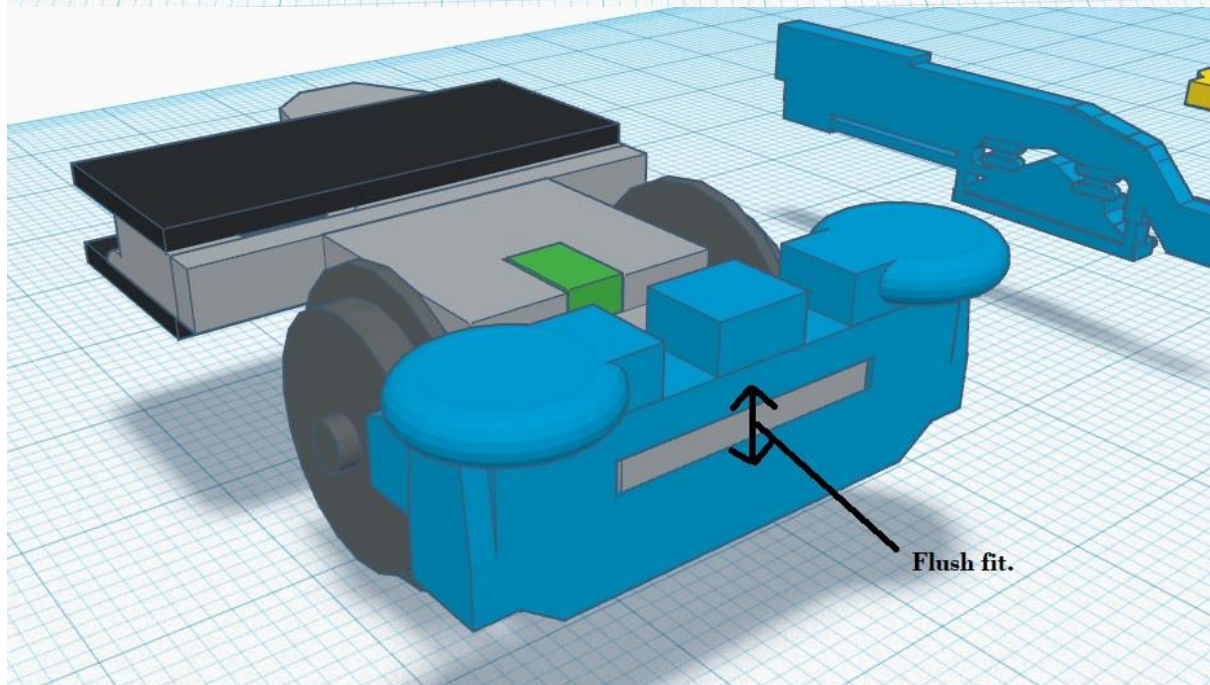
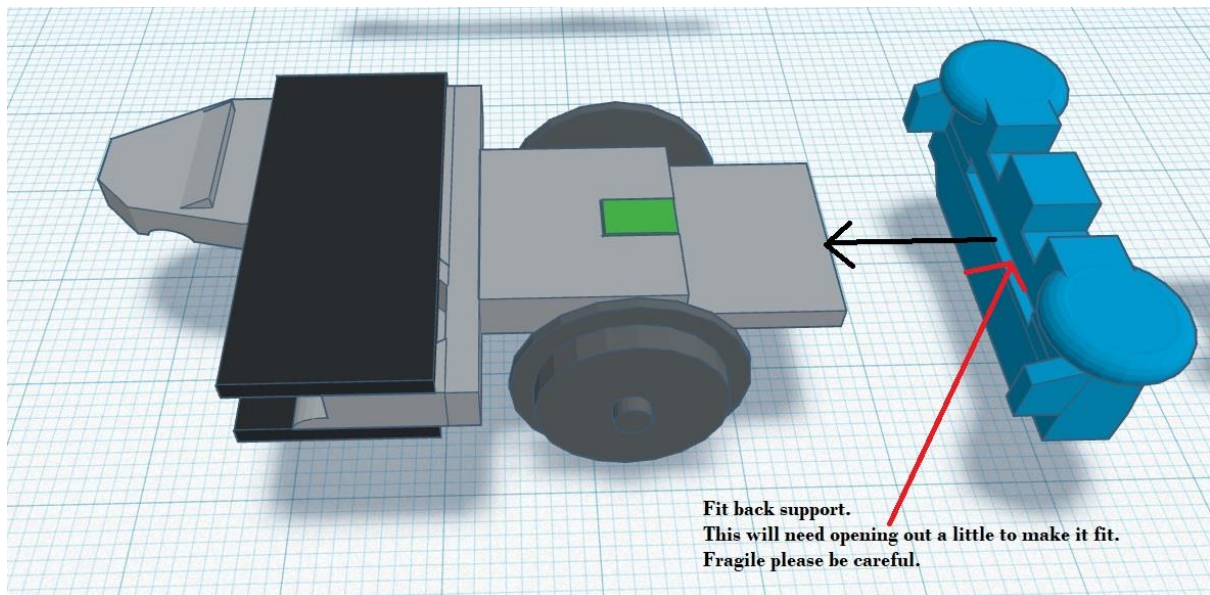

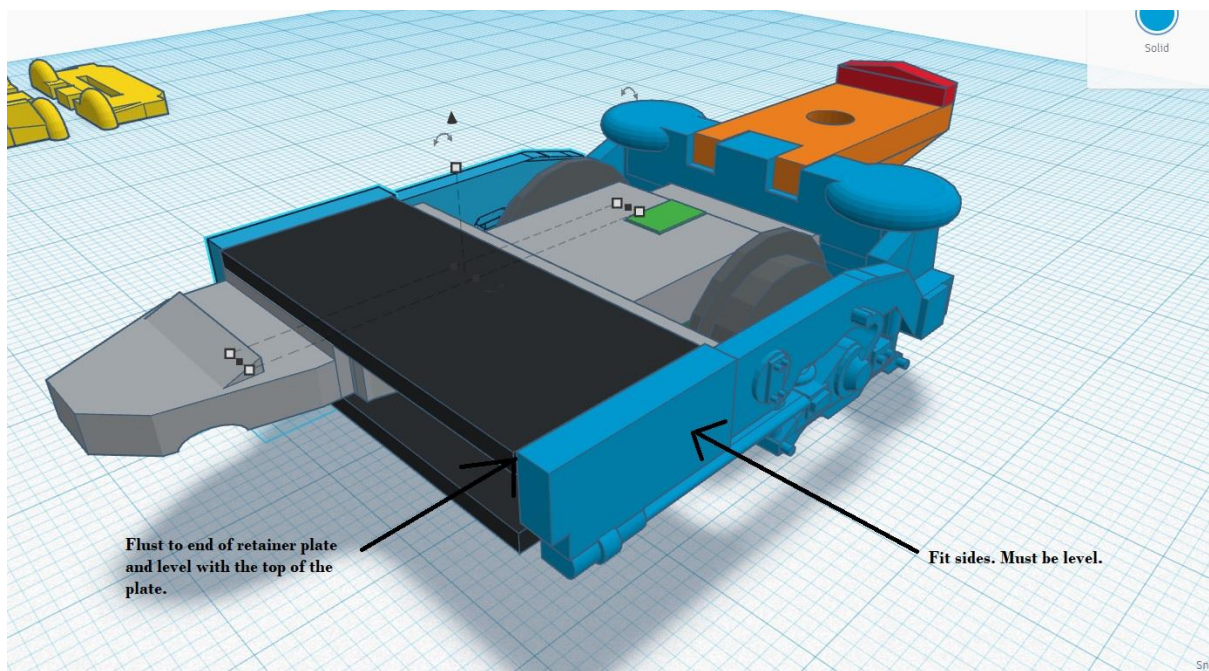
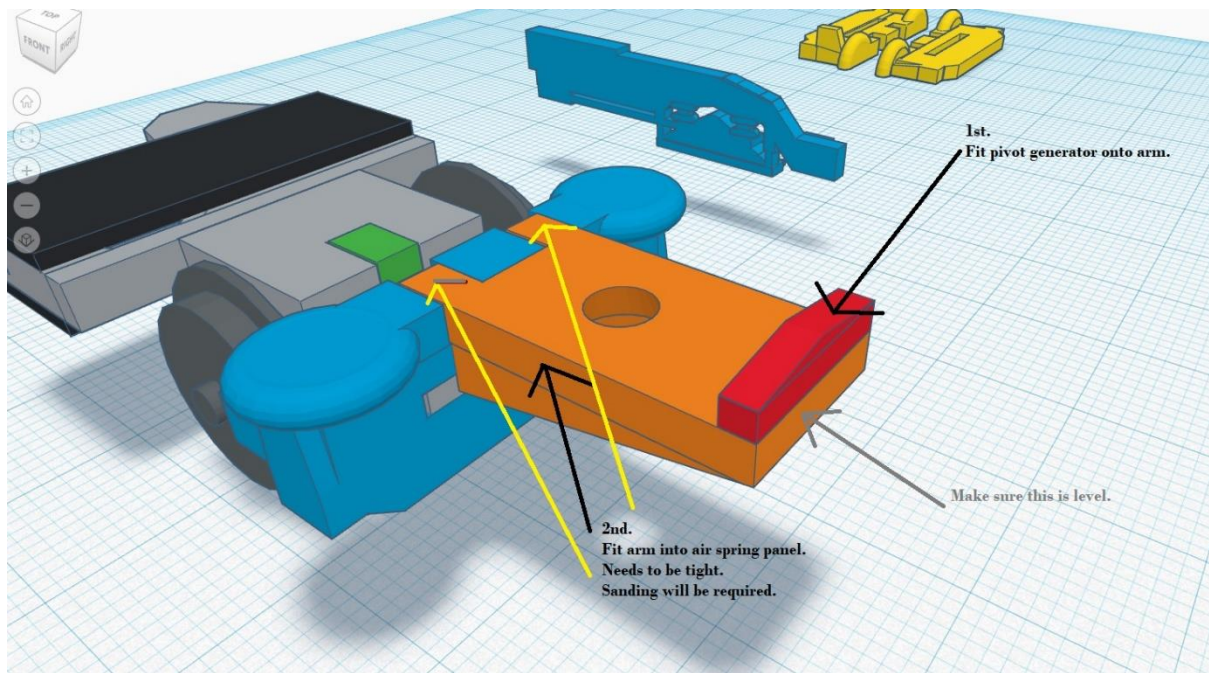

BT11 Half Bogie Completed.

Repeat another 3 times.

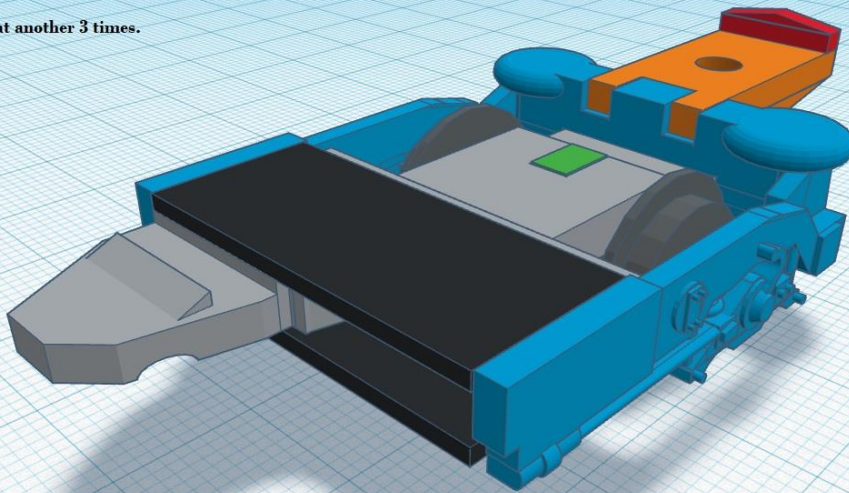

These bogies are designed to fit very tightly into the original Hornby bogies, so may need a little gentle twisting to fit correctly.

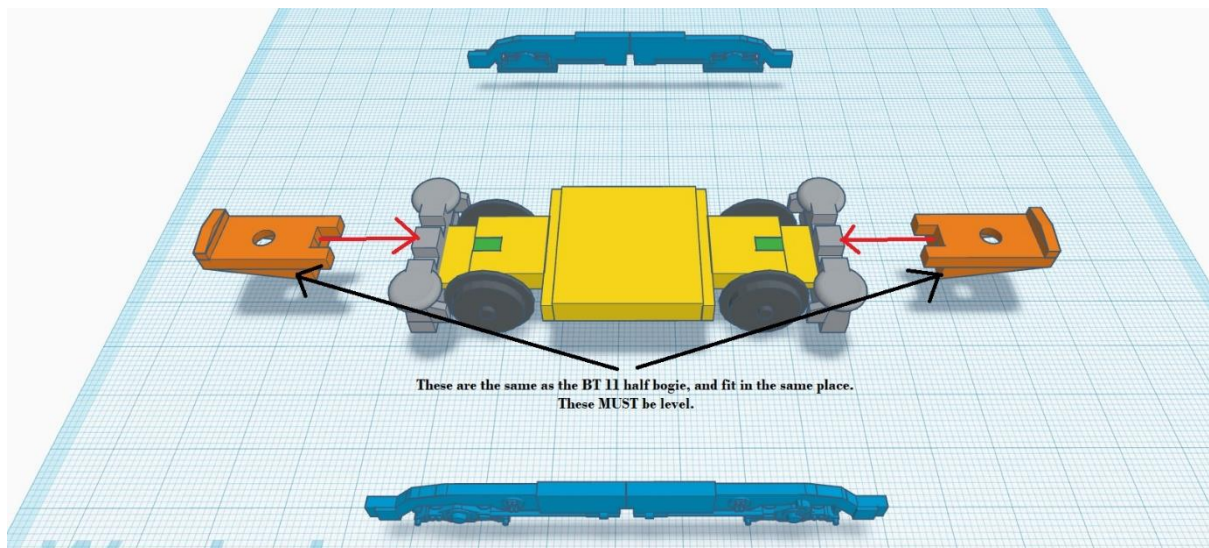
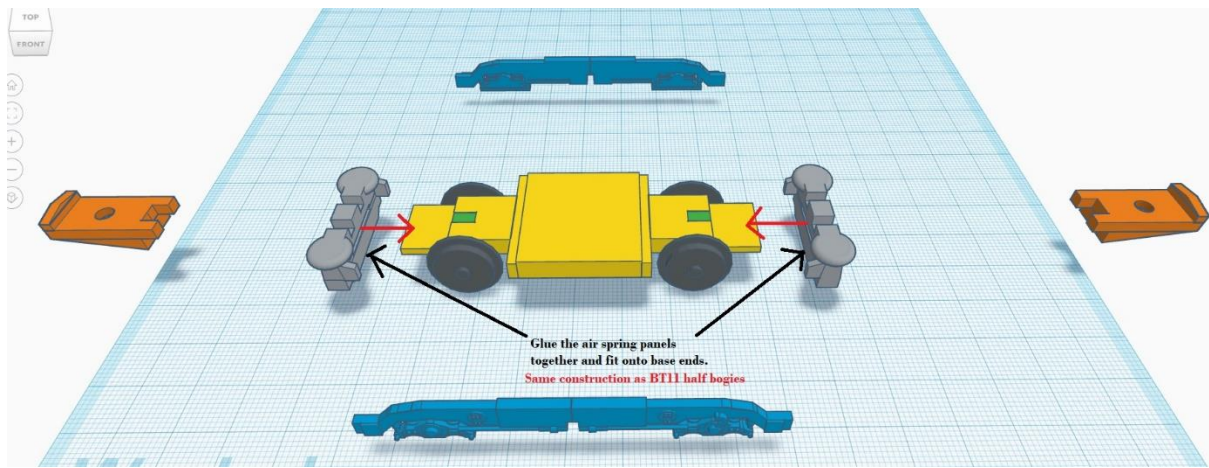
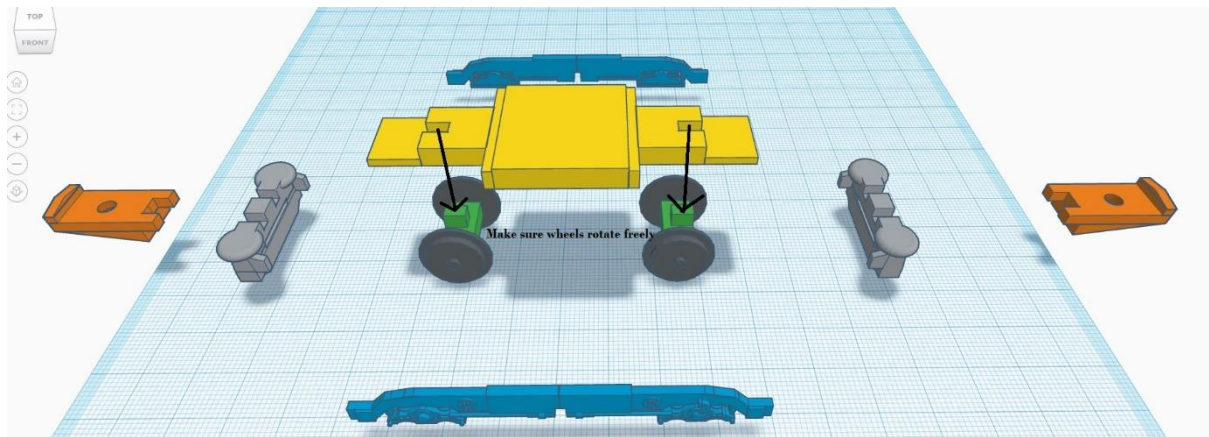

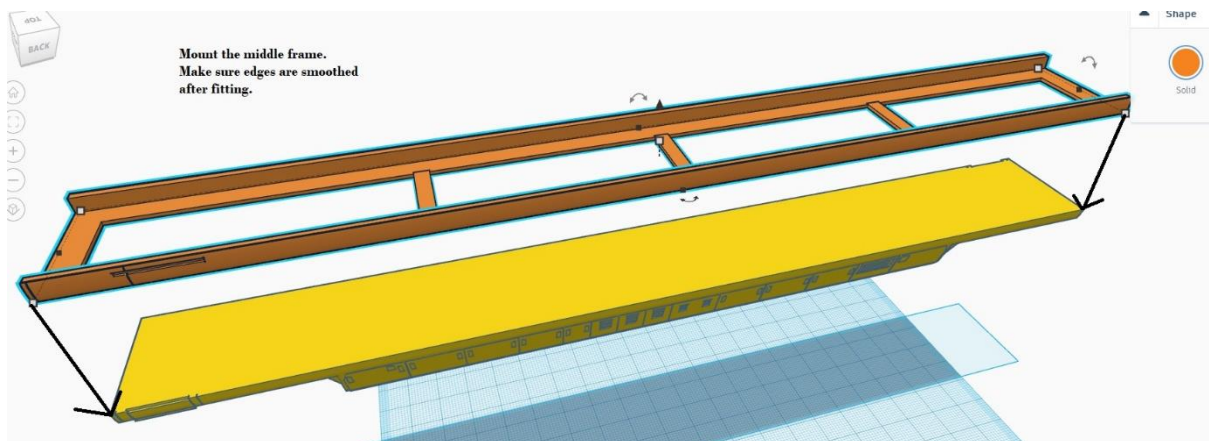
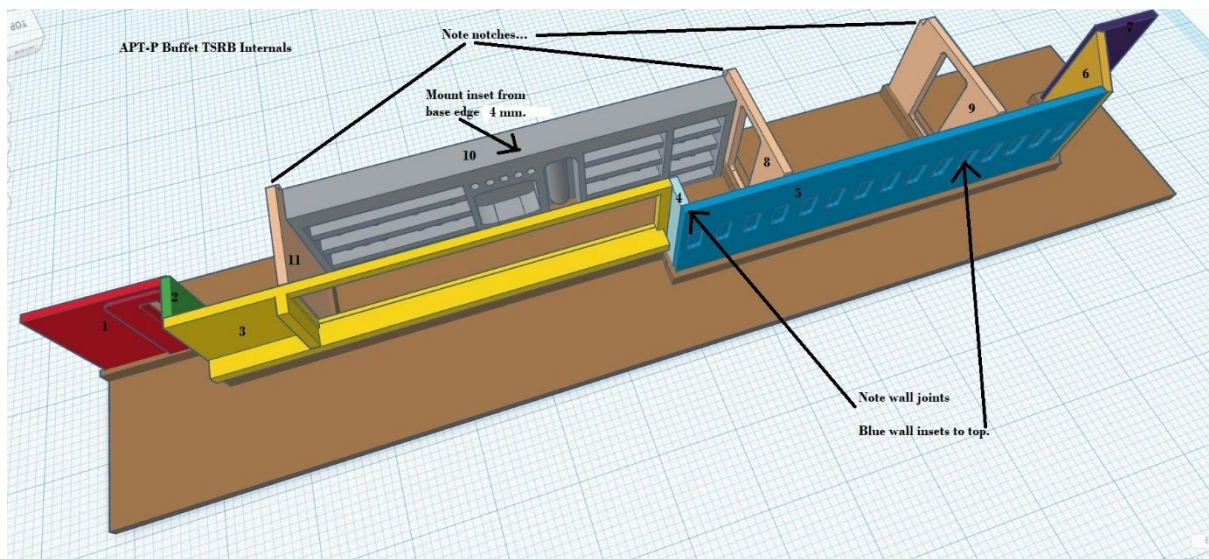
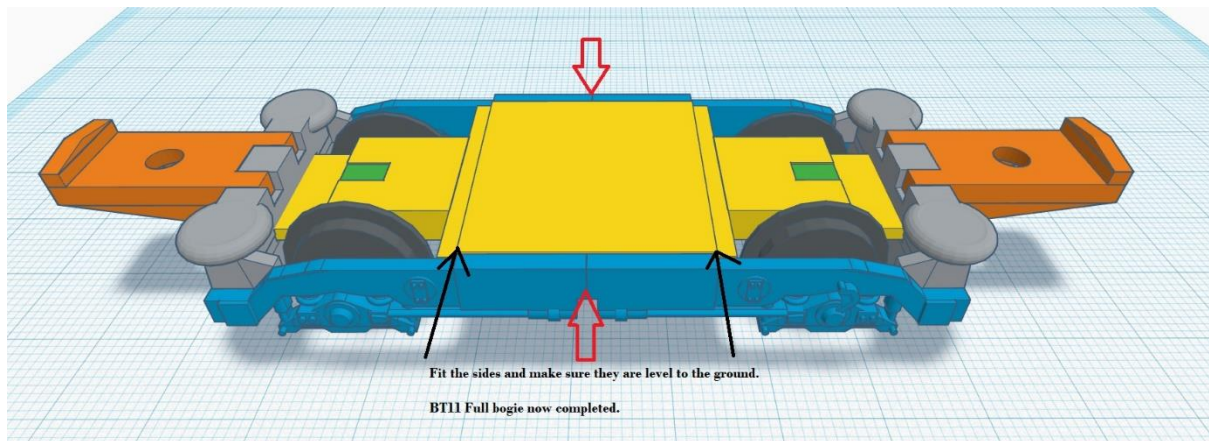

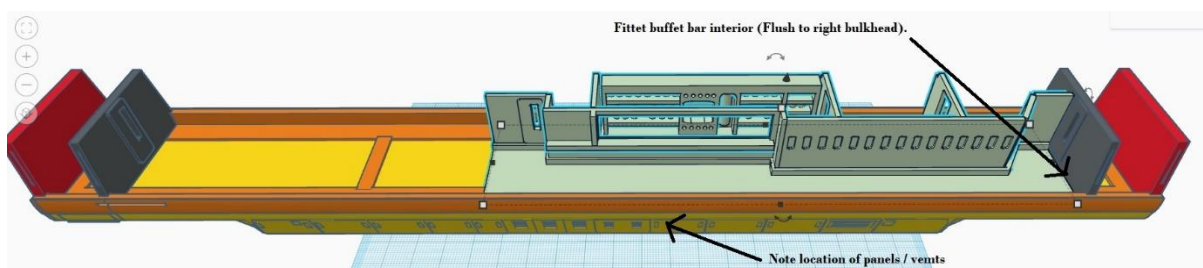
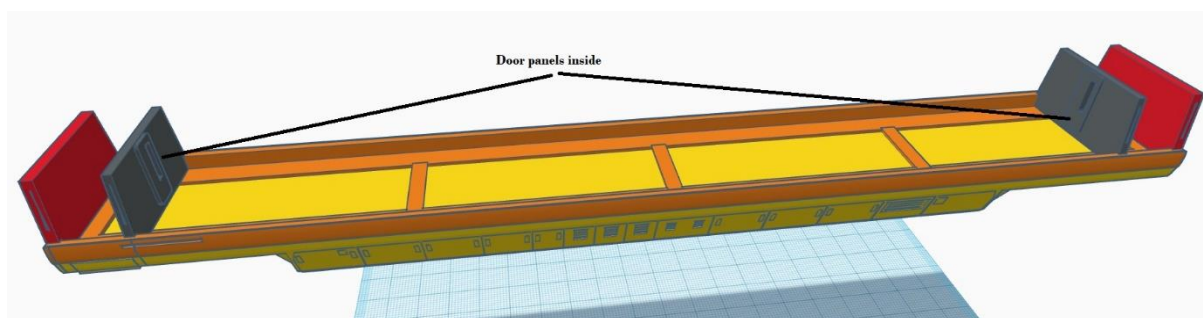
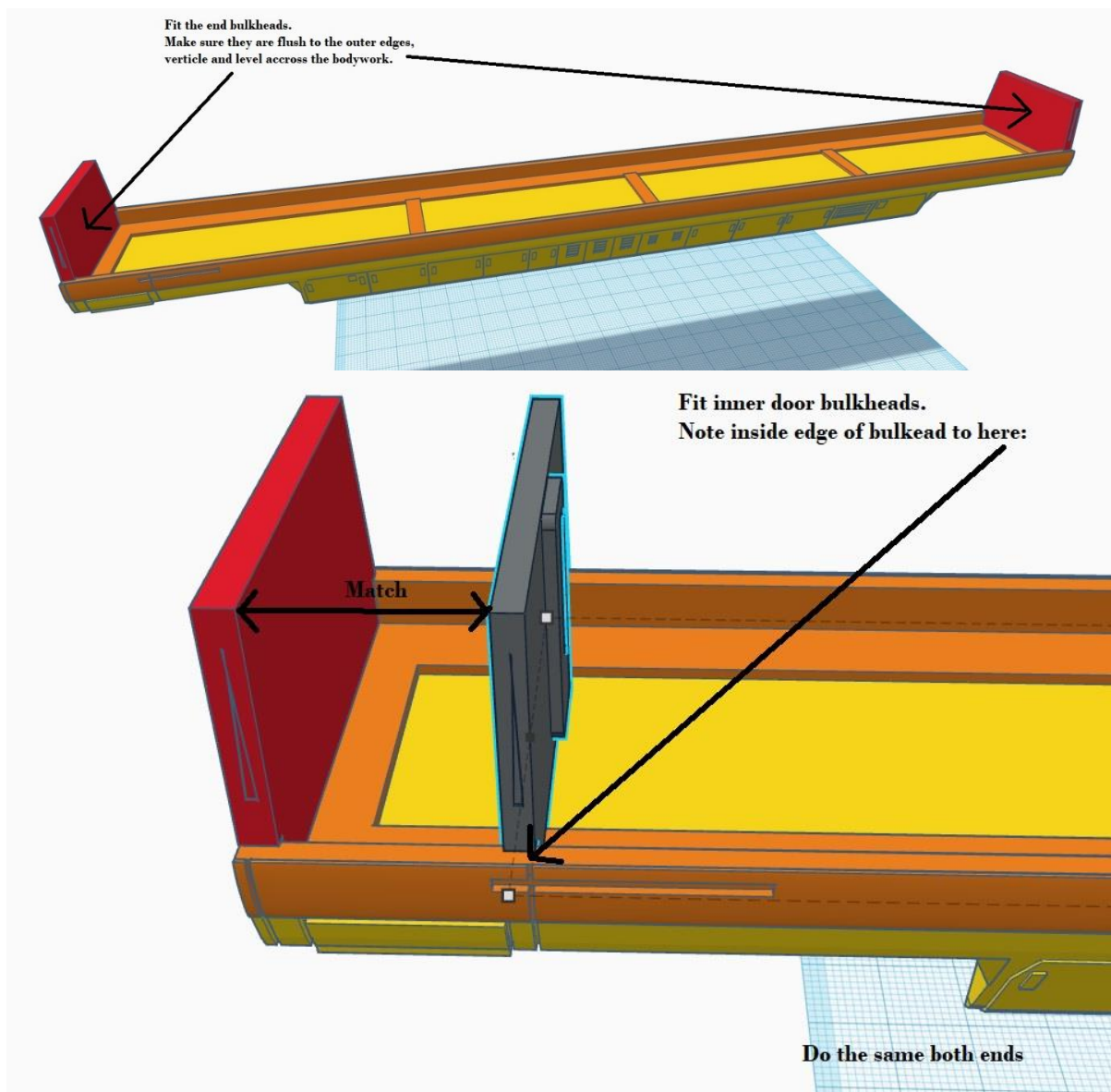

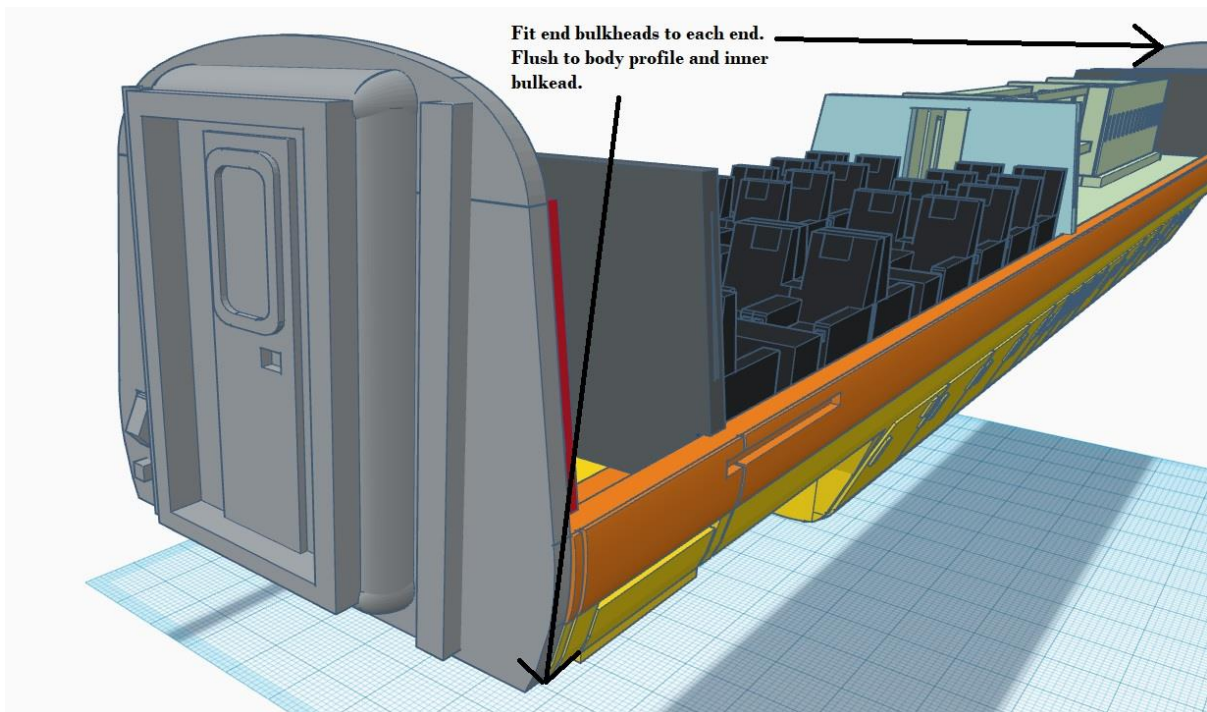
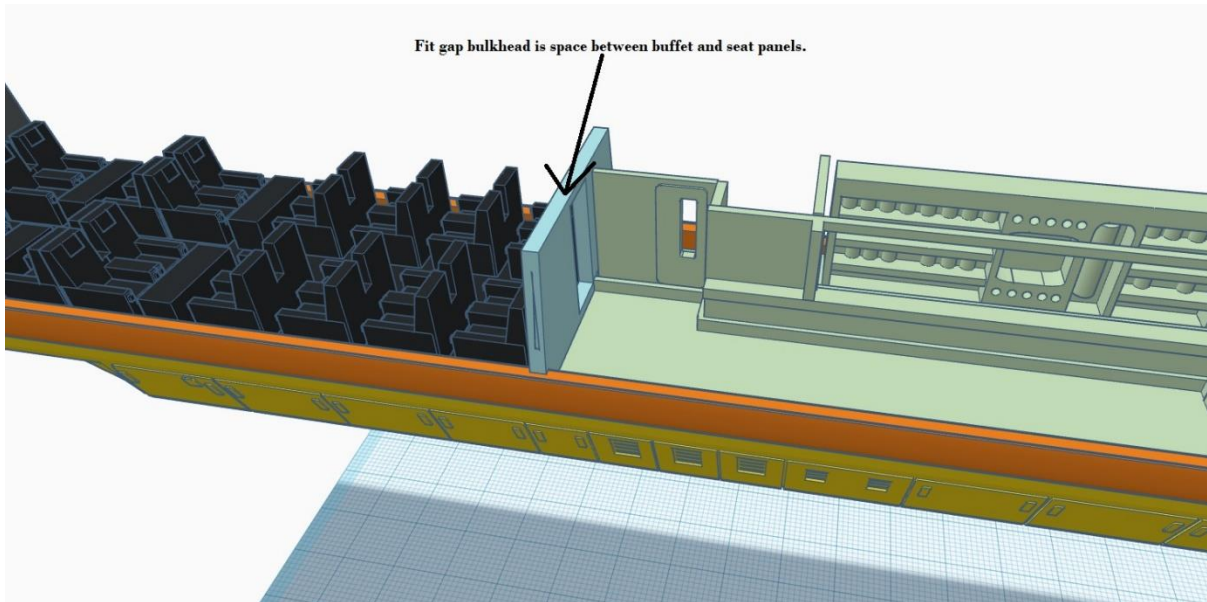
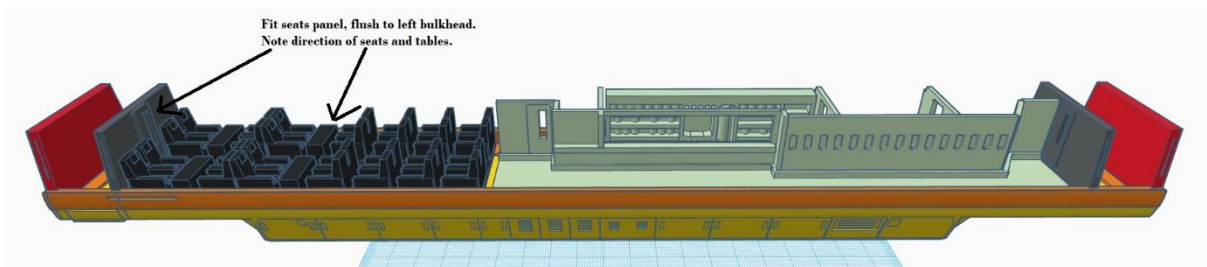

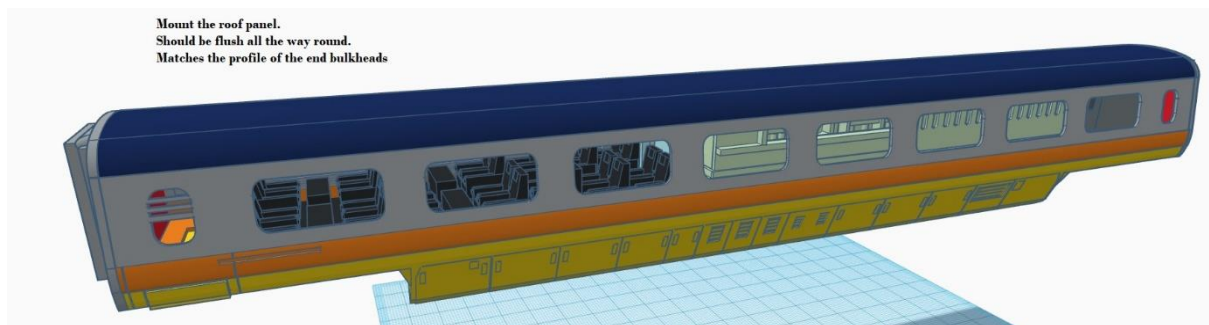
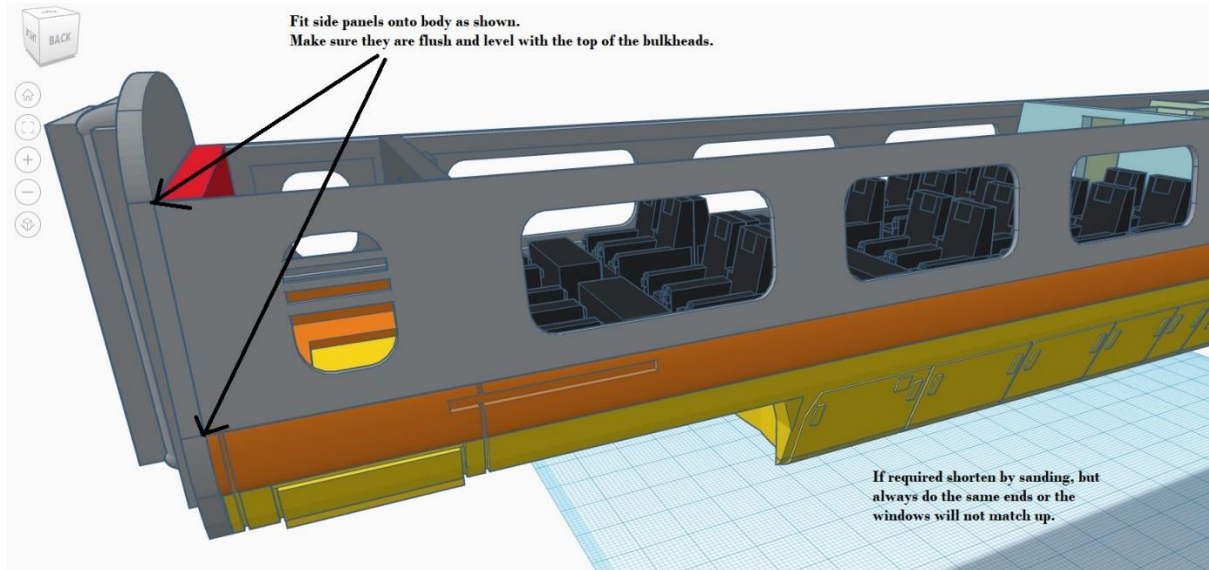
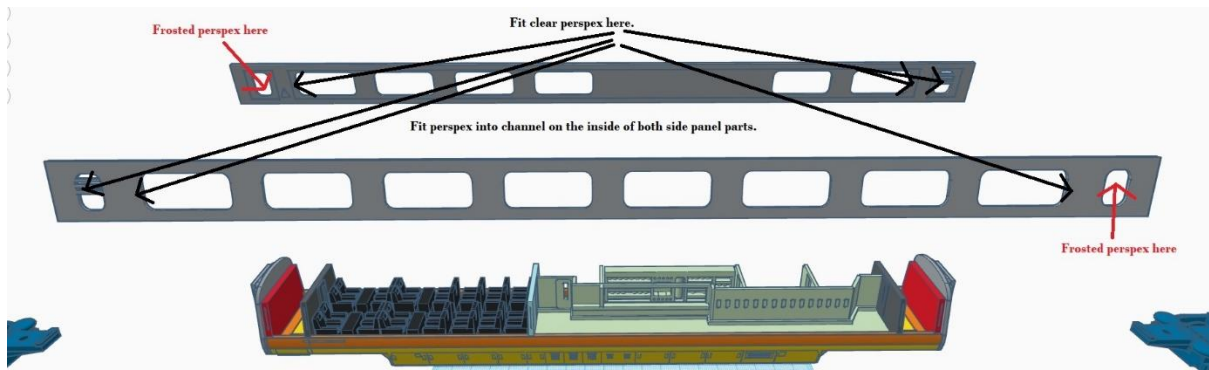

Mount the tilt points and pivots.
Same both ends.
Only use the TSRB version of the
buffet car.

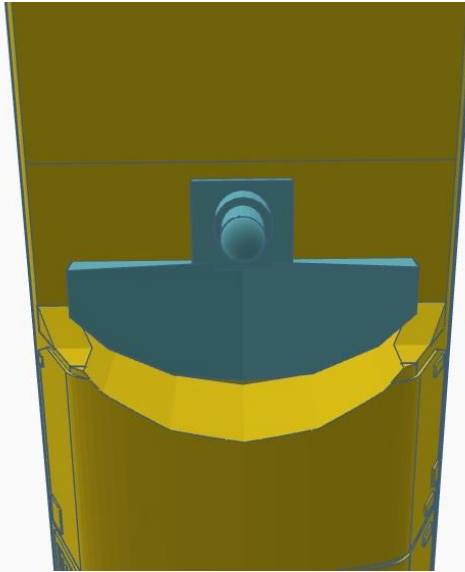

APT-P Buffet TSRB Completed.

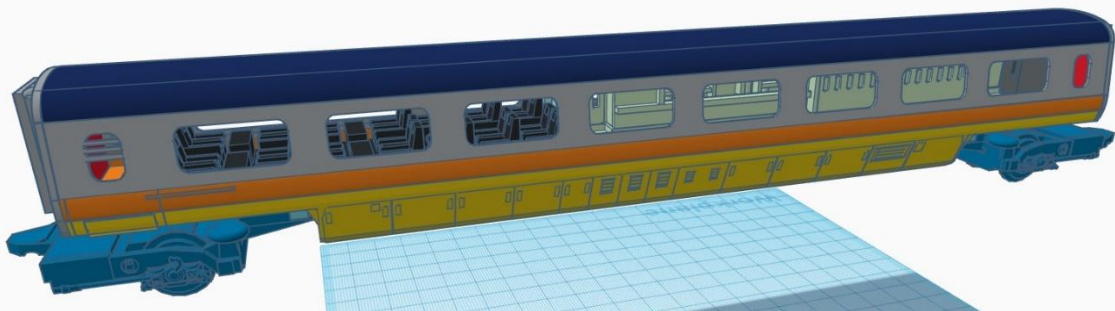

TS build is the same as Buffet until fitting internals.

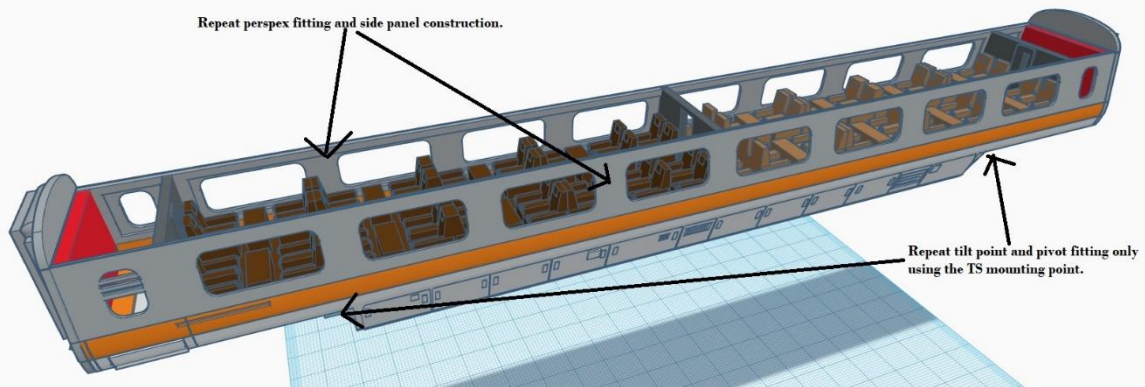
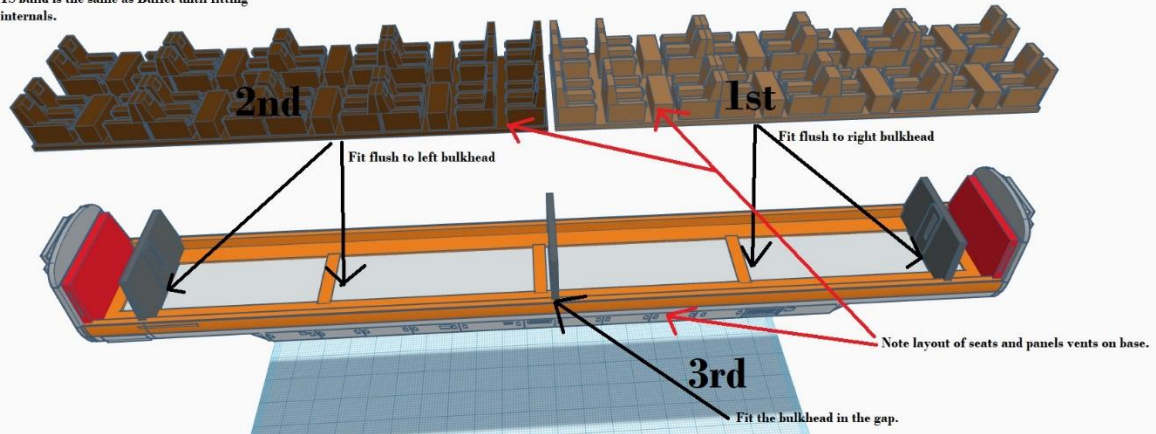

Fit the roof as before and you are done.

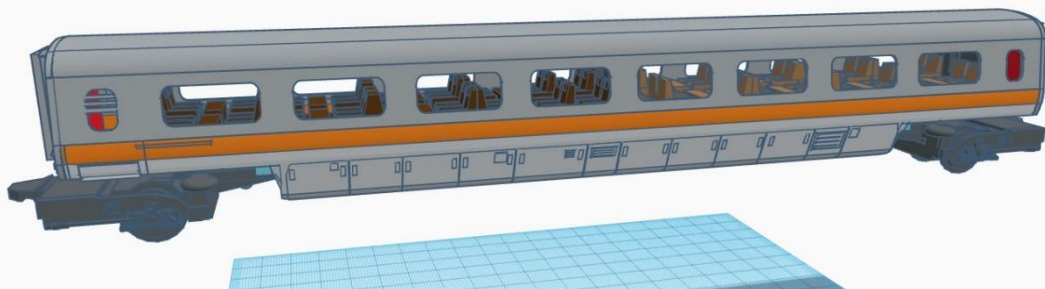
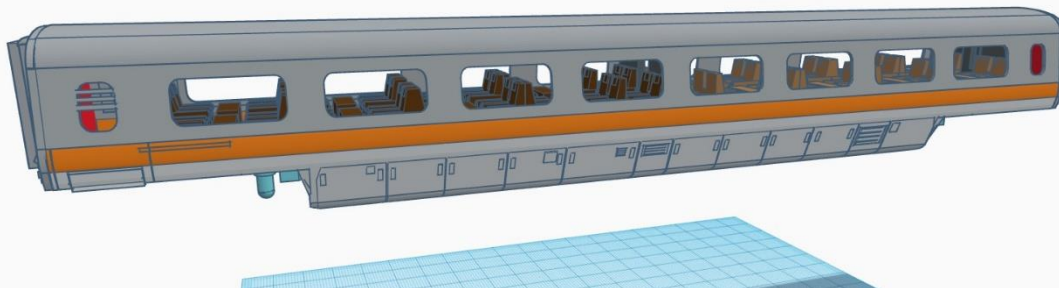

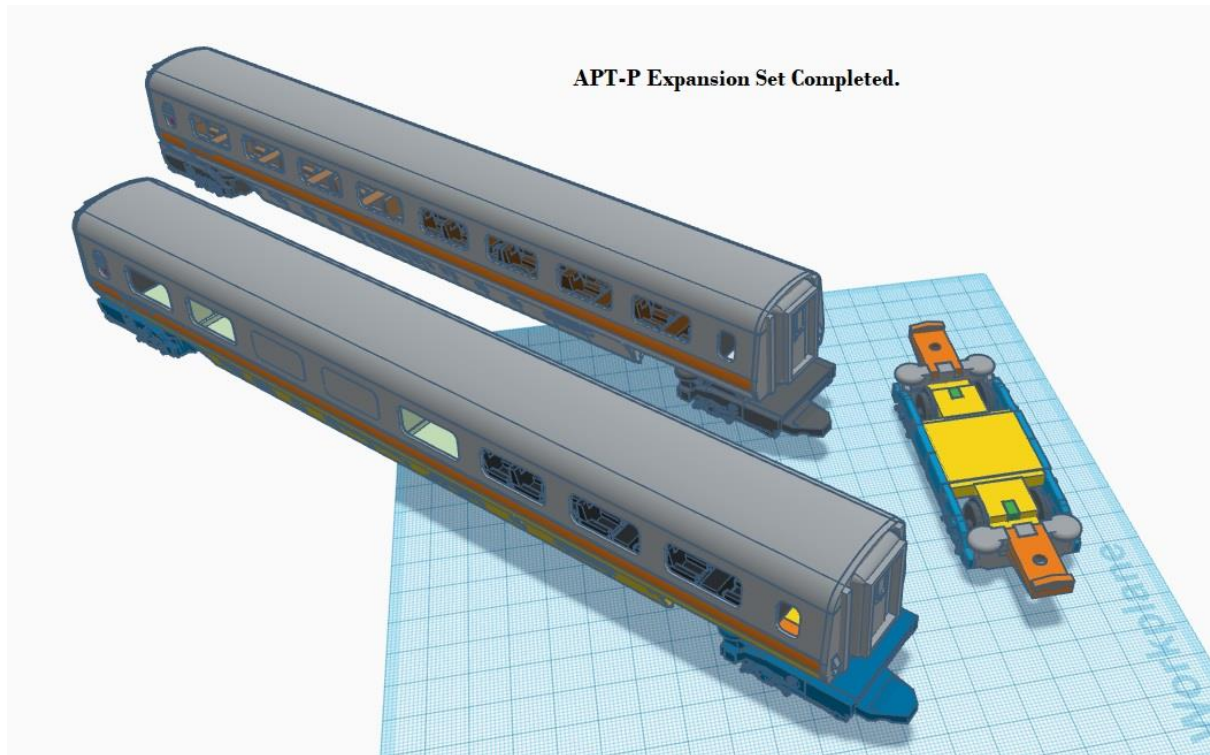

Hope you enjoy.

**Special thanks to :
Rob Latham (APT-P.COM)**